

RETAINERLESS LONG PATTERN TWIN PLATE

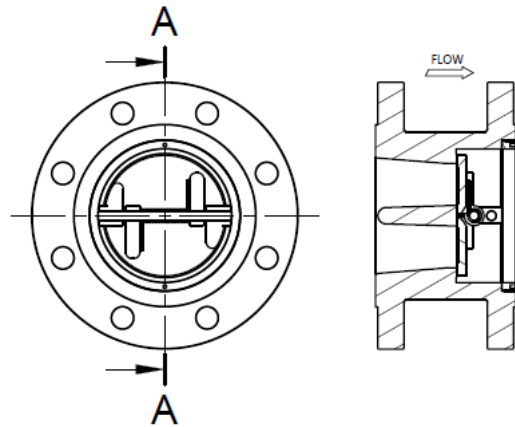

SPECIAL CHARACTERISTICS

- Lightweight
- Compact
- Economical
- No Leak Path to the Atmosphere
- Easily Installed
- Tight Shut-off (Resilient Seat)
- Anti-Slam
- Complies with API 594 except face to face
- Suitable for ASME B16:34 flanges



Model #	414	424	434	444	454	464	474	484
Body (See Table A)	Bronze	Carbon Steel	Carbon Steel	316 S.S.	Monel	Titanium	Hastelloy	D.S.S
Plates	Bronze	316 S.S.	316 S.S.	316 S.S.	Monel	Titanium	Hastelloy	D.S.S
Pin Carriers	Monel	316 S.S.	316 S.S.	316 S.S.	Monel	Titanium	Hastelloy	D.S.S
Pins	Monel	316 S.S.	316 S.S.	316 S.S.	Monel	Titanium	Hastelloy	D.S.S
Seat: (Metal) Suffix 'M' (Viton) Suffix 'V' 204°C (P.T.F.E) Suffix 'P' 250°C (Neoprene) Suffix 'N' 120°C Buna-N Suffix 'B' 120°C EPDM Suffix 'E' 120°C Peek Suffix 'K' 250°C	Max. Temp 260°C	Max. Temp 425°C	Max. Temp 425°C	Max. Temp 538°C	Max. Temp 475°C	Max. Temp 316°C	Max. Temp 675°C	Max. Temp 315°C
Spring:	Inconel 625 Inconel-X Titanium Hastelloy P.F.A Coated					Suffix 'I' Suffix 'X' Suffix 'T' Suffix 'H' Suffix 'C'		
Bearings	316 S.S.							

PRINCIPLE DIMENSIONS	CLASS 150				CLASS 300			
	50	80	100	150	50	80	100	150
Nominal Size 'DN' (mm)	50	80	100	150	50	80	100	150
Face to Face	114	121	121	130	114	121	121	130
Outside Diameter 'OD' (mm)	152	191	229	279	165	210	254	318
No. Of Holes 'N'	4	4	8	8	8	8	8	12
PCD (mm)	121	152	191	241	127	168	200	270
Hole Diameter 'ØH' (mm)	19	19	19	22	19	22	22	22
Approx. Mass (kg)	7	13	19	29	8	15	25	41

ASME B16:34 P/T Ratings
 Longer Face to Face options available
 Larger sizes and specials on request

Higher pressures on request
 Alternative Flange options available
 Alternative material configurations available

Abacus Valves International Ltd
 Block 4, Riverside Road,
 Paddockholm Ind. Est.,
 Kilbirnie. KA25 7EW
 t: +44(0)1505 681777
www.abacusvalves.com
sales@abacusvalves.com

Notes:

- Wafer pattern design offers significant space and weight reduction compared with traditional flanged valve design.
- Superior by design
- 24 hour quotation turn around
- Comprehensive stocks
- Worldwide distribution
- Technical assistance and advice always available



OUTSIDE DIAMETERS FOR WAFER CHECK VALVES

Size (mm)	Size (in)	PN6	PN10	PN16	PN25	PN40	Table 'D'	Table 'E'	ANSI 150	ANSI 300	ANSI 600	ANSI 900	ANSI 1500	ANSI 2500
50	2.0	98	109	109	109	109	99	99	105	111	111	143	143	146
65	2.5	118	129	129	129	129	111	111	124	130	130	165	165	168
80	3.0	134	144	144	144	144	130	130	137	149	149	168	174	197
100	4.0	154	164	164	170	170	162	162	175	181	193	206	209	235
125	5.0	184	194	194	196	196	194	194	197	216	241	247	254	279
150	6.0	209	220	220	226	226	219	214	222	251	266	289	282	317

Please note:

1. The check valves above are not suitable for heavily pulsating flow such as can be experienced to reciprocating pumps or compressors
2. If the wafer check valve you require is not shown or if you have a special design requirement, please contact us on +44 (0) 1505 681777 or sales@abacusvalves.com

Abacus Valves International Ltd
 Block 4, Riverside Road,
 Paddockholm Ind. Est.,
 Kilbirnie. KA25 7EW
 t: +44(0)1505 681777
www.abacusvalves.com
sales@abacusvalves.com

Notes:

- **Wafer pattern design offers significant space and weight reduction compared with traditional flanged valve design.**
- **Superior by design**
- **24 hour quotation turn around**
- **Comprehensive stocks**
- **Worldwide distribution**
- **Technical assistance and advice always available**