

# LONG PATTERN SPRUNG SWING TYPE WAFER CHECK VALVE

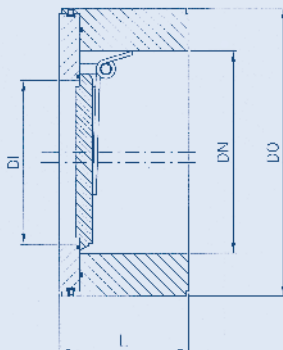
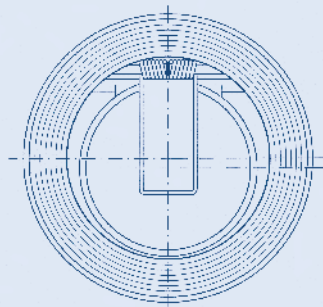

## SPECIAL CHARACTERISTICS

- Lightweight
- Compact
- Economical
- Easily installed
- Anti slam
- Tight shut-off (resilient seat)
- Low maintenance
- One piece disc and shaft for maximum strength
- Complies with API 594
- Suitable for all common flanges
- Retained disc

Model	518	528	548	558	568	578	588
<b>Body</b>	Bronze	Steel	316 S.S.	Monel	Titanium	Hastelloy	D.S.S.
<b>Seat Carrier</b>	Bronze	316 S.S.	316 S.S.	Monel	Titanium	Hastelloy	D.S.S.
<b>Disc</b>	Bronze	316 S.S.	316 S.S.	Monel	Titanium	Hastelloy	D.S.S.
<b>Pin</b>	Monel	316 S.S.	316 S.S.	Monel	Titanium	Hastelloy	D.S.S.

<b>Spring</b>	Inconel-X	Suffix 'X'
	Titanium	Suffix 'T'
	Hastelloy	Suffix 'H'
<b>Seat</b>	Metal	Suffix 'M'
	Viton	Suffix 'V'
	P.T.F.E.	Suffix 'P'

## Principle Dimensions

<b>Nominal size 'DN' (mm)</b>	40	50	65	80	100	125	150	200	250	300
<b>Intlet bore 'DI' (mm)</b>	26	35	46	57	80	102	125	166	208	250
<b>Length 'L' (mm)</b>	60	60	67	73	73	86	98	127	146	181
<b>Outside diameter 'DO' (mm)</b>	See table on page 3									
<b>Weight (Kg)</b>	2	3	4	5	7	14	15	30	50	90

Working temperatures up to 600°C

Working pressures up to 100 Bar

Lugged style on request

Larger sizes on request

Higher pressures on request

## Abacus Wafer Check Valves

t: +44 (0)1505 681777

f: +44 (0)1505 683999

www.abacusvalves.com  
sales@abacusvalves.com

Block 4 Lochshore East  
Industrial Estate Glengarnoch  
Ayrshire KA14 3DB

## NOTES

- Wafer pattern design offers significant space and weight reduction compared with traditional flanged valve design
- Superior by design
- 24 hour quotation turn around
- Comprehensive stocks
- Worldwide distribution
- Technical assistance and advice always available