

# SHORT PATTERN TWIN PLATE WAFER CHECK VALVE

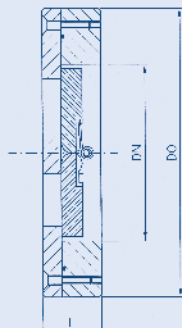
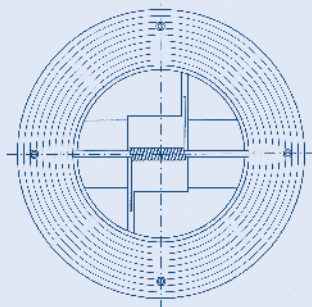

## SPECIAL CHARACTERISTICS

- Lightweight
- Compact
- Economical
- Easily installed
- Tight shut-off (resilient seat)
- Suitable for all common flanges
- Anti slam

Model	917	927	947	957	967	977	987
<b>Body</b>	Bronze	Steel	316 S.S.	Monel	Titanium	Hastelloy	D.S.S.
<b>Seat Carrier</b>	Bronze	316 S.S.	316 S.S.	Monel	Titanium	Hastelloy	D.S.S.
<b>Plates</b>	Bronze	316 S.S.	316 S.S.	Monel	Titanium	Hastelloy	D.S.S.
<b>Pin</b>	316 S.S.	316 S.S.	316 S.S.	Monel	Titanium	Hastelloy	D.S.S.

<b>Spring</b>	Inconel	Suffix 'I'
	Inconel-X	Suffix 'X'
	Titanium	Suffix 'T'
	Hastelloy	Suffix 'H'

<b>Seat</b>	Metal	Suffix 'M'
	Viton	Suffix 'V'
	P.T.F.E.	Suffix 'P'

## Principle Dimensions

<b>Nominal size 'DN' (mm)</b>	50	65	80	100	125	150	200	250	300
<b>Min. out. pipe bore (mm) (metal)</b>	50	65	80	100	125	150	200	250	300
<b>Length 'L' (mm)</b>	17	20	24	27	32	32	45	47	58
<b>Outside diameter 'DO' (mm)</b>	See table on page 3								
<b>Weight (Kg)</b>	2	3	4	5	7	8	20	35	60

Working temperatures up to 600°C  
 Working pressures up to 100 Bar  
 Lugged style on request

Larger sizes on request  
 Higher pressures on request

### Abacus Wafer Check Valves

t: +44 (0)1505 681777  
 f: +44 (0)1505 683999

www.abacusvalves.com  
 sales@abacusvalves.com

Block 4 Lochshore East  
 Industrial Estate Glengarnoch  
 Ayrshire KA14 3DB

### NOTES

- Wafer pattern design offers significant space and weight reduction compared with traditional flanged valve design
- Superior by design
- 24 hour quotation turn around
- Comprehensive stocks
- Worldwide distribution
- Technical assistance and advice always available